

KITCHEN

AND BATH IDEAS

FREE!

Open Up

A confined kitchen is re-created with an open floor plan and updated amenities.

WRITTEN BY
MEGAN BOETTCHER

the problems

■ IT FEELS DARK AND SMALL

The kitchen is tight and disconnected from the rest of the home. Dark cabinetry makes the room feel heavy.

■ POOR WORK FLOW

There is a lack of open counter space for preparing meals and cleaning up.

■ OUTDATED CABINET DESIGN

Placing cabinets under a soffit and above the peninsula was standard operation 30 years ago. Today's multitasking cooks prefer open sight lines to chat with family and friends while making dinner.

■ SAFETY CONCERNS

The cabinet to the right of the stove rests on the countertop. It is too close to the burners—creating a fire hazard.

■ MICROWAVE IS TOO HIGH

Installed above the range, the microwave is too high to be safely accessible to everyone in the home—especially children.

the solutions

■ CREATE A PARTIAL WALL

Removing half of the range wall opens the kitchen to the dining room and adds 13 inches to the countertop.

■ DEFINE WORK ZONES

There are countertop areas that function well as work zones for meal preparation and cleanup. There is also a baking center between the fridge and oven.

■ REMOVE PENINSULA

To open the kitchen to the adjacent living room, the peninsula and overhead cabinets are removed.

■ EXTEND CABINETS

Without a soffit, wall cabinets extend to the ceiling, offering additional storage space. Crown molding adds decorative details to the cabinetry.

■ INCLUDE AN OVEN WALL

An oven wall, built at a slight angle, creates a little separation between the kitchen and living room. It also places appliances at an accessible height.

18x18-inch vinyl tile | \$3.99 per square foot
The Home Depot
homedepot.com

GE Monogram 30-inch oven
ZET1RMSS | \$2,616
GE Appliances
800/444-1845
monogram.com

Baltic Granite laminate
countertop and backsplash |
prices vary
Formica Corp.
800/367-6422
formica.com

Ferrara faucet LK7620 | \$437
Elkay Manufacturing Co.
630/572-3192
elkayusa.com

the solutions

■ RAISE PARTIAL WALL

Adding 8 inches to the partial range wall hides what is on the cooktop but preserves the open feel. The higher ledge is also used for a serving area.

■ ENLARGE THE WINDOW

A wider window over the sink allows more natural light into the kitchen.

■ DIFFERENTIATE CABINETS

Standard 12-inch-deep wall cabinets flank the window. To add variety and storage, glass-front cabinets that stretch from the ceiling to the countertop are 14 inches deep.

■ ADD A HUTCH

A floor-to-ceiling, glass-front hutch installed at the end of the sink wall lengthens the kitchen and adds storage.

■ UPGRADE APPLIANCES

Refrigerator drawers, a double wall oven, an induction cooktop, and a cabinetry-front refrigerator transform this modest space into high-end beauty.

Isparta Chiseled 6x6-inch tile
| \$6.84 per square foot
Arizona Tile
480/893-9393
arizonatile.com

E-series 30-inch double oven
| \$6,005
Wolf Appliance Co.
800/332-9513
wolfappliance.com

MoSuprema tile | \$64 per
square foot
Sonoma Tilemakers
707/837-8177
sonomatilemakers.com

TFC 480 faucet | \$1,205
Franke Kitchen Systems
800/626-5771
franeksd.com



Tam Newell, a certified kitchen designer (CKD), a certified bath designer (CBD), and an Allied Member of the American Society of Interior Designers (ASID) at Affinity Kitchens in Tucson, has designed kitchens for 26 years.

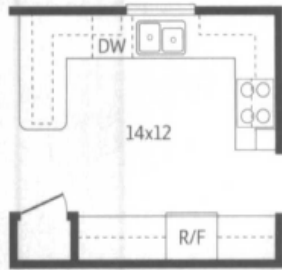

BEFORE

Value





AFTER

value budget breakdown

APPLIANCES

GE Monogram 36-inch refrigerator	\$ 5,835
GE Monogram 30-inch oven	\$ 2,616
GE Advantium Speedcook microwave oven	\$ 1,493
GE 36-inch glass canopy island hood	\$ 1,476
GE Monogram SS dishwasher	\$ 1,321
GE Monogram 30-inch electric cooktop	\$ 1,236

CABINETS

Affinity Design Group, Berkeley style in Nutmeg finish on cherry	\$18,500
--	----------

SURFACES

Formica Baltic Granite laminate countertop	\$ 3,692
18x18-inch vinyl tile flooring	\$ 452

MISCELLANEOUS

Franke Regatta sink RGX160	\$ 458
Elkav Ferrara faucet LK7620	\$ 437

TOTAL **\$37,516**

prices are estimates, excluding installation

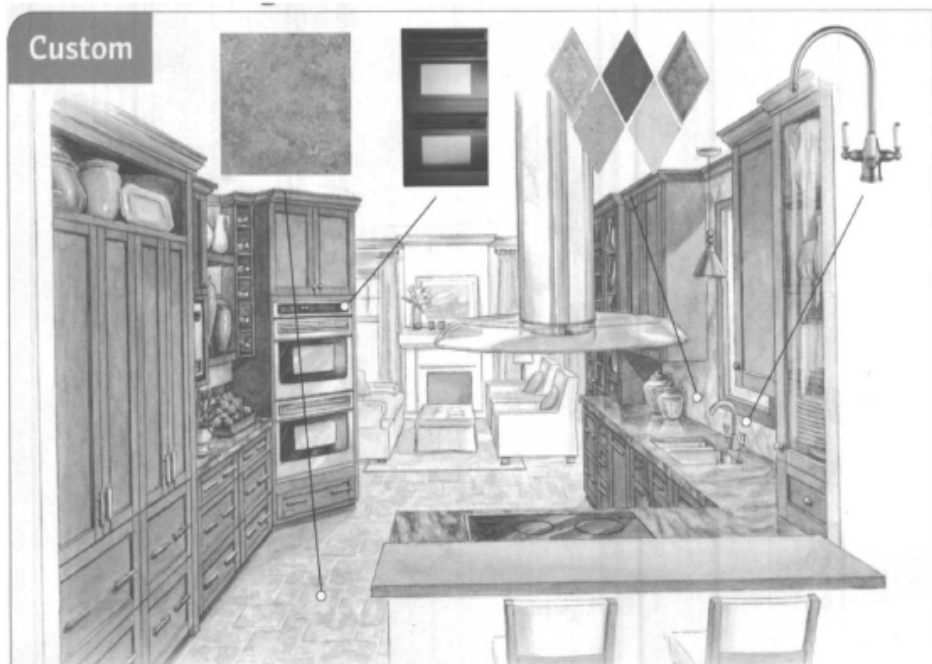

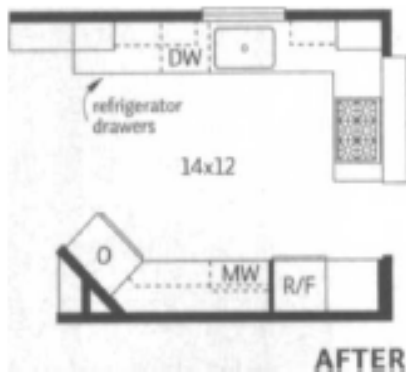

custom budget breakdown

APPLIANCES

Sub-Zero 27-inch refrigerator/freezer	\$ 5,595
Wolf 30-inch double convection oven	\$ 6,005
Best by Broan glass-and-stainless-steel hood	\$ 4,275
Sub-Zero 27-inch refrigerator drawers	\$ 3,280
Wolf 30-inch induction cooktop	\$ 2,940
Asko dishwasher	\$ 1,625
Sharp over-the-counter microwave oven	\$ 509

CABINETS

Affinity Design Group, Parklane style in Java finish on cherry	\$43,125
---	----------

SURFACES

Magma granite countertop	\$ 7,900
Sonoma Tilemakers backsplash tile	\$ 2,418
Spekva countertop on partial wall	\$ 1,590
Arizona Tile 6×6-inch stone tile flooring	\$ 890

MISCELLANEOUS

Franke faucet TFC 480	\$ 1,205
Elkay sink ELUH3120L	\$ 818

TOTAL

\$82,175

prices are estimates, excluding installation

KITCHEN

FREE! AND BATH IDEAS

Go with the Flow

Kitchen sinks and faucets are beautiful and versatile. With almost endless options, you are sure to find a look to fit your style.

WRITTEN BY
MEGAN BOETTCHER

FROM FAUCETS WITH SLEEK contemporary lines to wide apron-front sinks, there are so many choices when it comes to kitchen faucets and sinks it can be a bit overwhelming. To find what's right for your kitchen, start with style. Is your home contemporary or traditional? Is it formal or casual? Simple or ornate?

Then take time to consider color and materials. If you want a sink that blends into the background, an undermount sink in stainless steel or stone might be the right solution. If you're looking to make a statement, an apron-front sink in hammered copper or a colored ceramic sink may be your best bet.

Faucets have a vast range of finishes. From chrome to brushed nickel to oiled bronze, each gives the faucet a signature look. The faucet height and whether or not it has a pullout spout affect its functionality. After all, a faucet should both look beautiful and aid efficiency.

Top-of-the-Line Fixtures

Indulge in a high-end faucet or sink that makes a statement of elegance in any kitchen.

OVER OR UNDER

Undermount sinks are installed below the countertop. They are popular because they blend in with a room's decor. The seamless design of an undermount sink also makes cleanup a breeze. One drawback is that undermount sinks tend to cost more. Self-rimming sinks rest directly on the countertop. They are easy to install, and are generally less expensive.

2. FARM FRESH

The seamless design of this simple apron-front sink is made with Corian surfacing. Chandler Corian Plain Front Apron Sink | \$1,414–\$1,477
American Standard
800/442-1902
americanstandard-us.com

3. SMOOTH LINES

Available in a single- or double-basin style, this polished-stone sink comes in four natural stone options. Polished Farmsink | \$1,750–\$2,100
Stone Forest
888/682-2987
stoneforest.com

1. BRIDGE BEAUTY

This stunning bridge faucet has a raised spout height, offering efficient and flexible function.

HiRise K-7337-4 | from \$950
Kohler
800/456-4537
us.kohler.com

4. WATER PUMP

This faucet—in an oiled-bronze finish—brings the timeless look of a farmyard pump to the modern kitchen. Oldare Faucet | from \$745
Elkay
630/572-3192
elkayusa.com



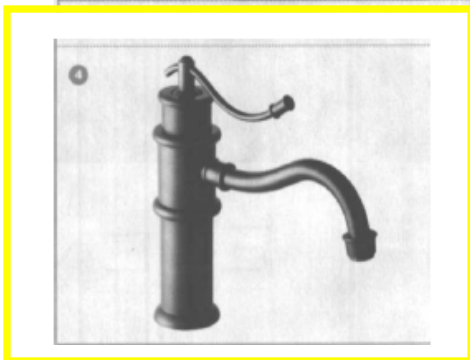

Sensible Splurges

Stylish and innovative faucets and sinks don't have to cost a fortune. These moderately priced fixtures are true gems.

1. ORNATE STYLE

In an oil-rubbed bronze finish, this rustic-style faucet sports a swivel spout. It is available in more than 35 finishes.

Santa Barbara Kitchen Faucet 5410 | \$582

California Faucets
800/822-8855
calfaucets.com

2. SLIDE RIGHT

This multilevel sink features a sliding cutting board, custom colander, and three sink grids.

Precis Multilevel Sink |

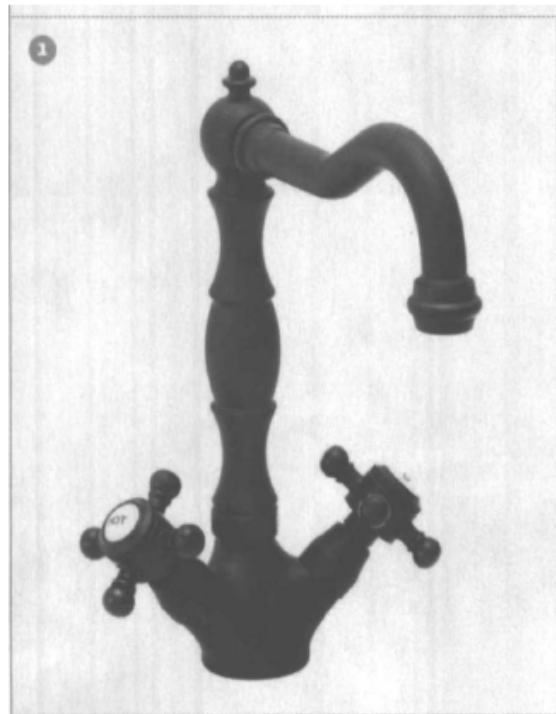

\$1,195

Blanco America, Inc.
800/451-5782
blancoamerica.com

3. POT WASHER

The large stepped basin design of this cast-iron kitchen sink easily accommodates oversized cookware.

Carrizo Kitchen Sink | from \$612

Kohler
800/456-4537
us.kohler.com

4. MODERN ANGLES

The clean lines and subtle curves of this faucet give it a contemporary edge.

Axor Citterio Kitchen Faucet | from \$566

Hansgrohe, Inc.
800/334-0455
hansgrohe-usa.com



Frugal Finds

Purchase a reasonably priced sink or faucet, and save a little extra in your kitchen budget for more expensive components.

STAINLESS STEEL DECODED

Stainless steel is a great material for kitchen sinks because it is extremely durable. However, when you are shopping for a stainless-steel sink, the gauge ratings can be confusing. The gauge is the thickness of the metal and is important when selecting a stainless-steel sink. The lower the gauge, the thicker, heavier, and more durable the steel. The highest-quality stainless-steel sinks have a gauge of 16. The price of stainless-steel sinks also increases as the gauge thickens.

1. WORK CENTER

Featuring a range of accessories, this sink is available exclusively at



The Home Depot.
Pegasus Granite Kitchen Sink | \$349
Pegasus
800/553-3199
pegasusinfo.com

2. HIGH TOP

The tall, sophisticated arc of this faucet is reminiscent of classic European style.

Treviso Single Handle Kitchen Faucet | from \$188

Price Pfister
800/732-8238
pricepfister.com

3. LONG SHOT

A pullout spout with a 68-inch hose adds reach to this versatile single-handle faucet.

Camerist with Pull-Out Spout | \$265

Moen
800/553-3199
moen.com

4. SILENT SINK

This 20-gauge stainless-steel undermount sink works well alone or in tandem.

Artisan ARX110-14 | \$400

Franke USA
800/626-5771
frankeus.com

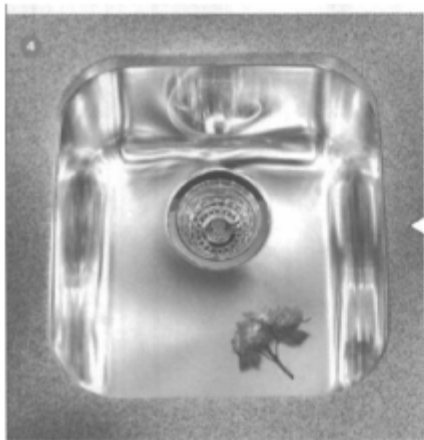

HOSE LENGTH

Pullout spout faucets are popular because they eliminate the need for a separate sprayer. Be sure to select a hose long enough to spray every corner of the sink.

Editor's Pick

This faucet with a pullout spout has style and function.

Torrance faucet | from \$363

Moen, Inc.
800/289-6636
moen.com