

kitchen
SOLUTIONS

2008 WINNERS

BEST ADVICE FROM TOP DESIGNERS

stately
GREEN, CLEAN KITCHEN
UPDATES A 1980S DESIGN
scandinavian

WISH LIST

- Update the look of an early-1980s kitchen
- Improve its function, since it hadn't been laid out well
- Open the kitchen to an adjacent family room and the outdoors

With their children grown, a couple living in Minnesota decided it was time to replace the dated 1980s kitchen in the suburban house where they had lived for about 15 years. They wanted to be able to entertain more, which led to a request to open the kitchen to an adjacent family room and refine both spaces with some spare Scandinavian styling. With design help from architect Mark Larson of Rehkamp Larson Architects, Inc. in Minneapolis, Minnesota, they gained a clean, fresh, unique expanse with some rearranged doorways, large unadorned windows, a warm oak floor (the same oak frames their south-facing windows), dark charcoal

honed granite and oak countertops, and—the biggest surprise of all—bold, apple green-painted cabinets and island.

Larson, who works with his wife, architect Jean Rehkamp Larson, wanted the redesigned rooms to look like they belonged with the rest of the house but to reflect some smarter design choices. "The kitchen didn't get bigger; it got better," he says. To achieve this, he used quartersawn oak rather than the original oak trim that the builder had used, since he felt it showed less grain. "The quartersawn is cleaner and tighter looking, since it's a more refined cut," he says. Because a simple cabinet seemed to offer the right aesthetic, Larson selected a minimally adorned rail design that would look good in green and could be embellished with old-fashioned-style pulls. The same style cabinet was used for the island, which contains no appliances, by owner's request.

One of Larson's favorite results is the arrangement of appliances. The sink, dishwasher and range top were organized in the shape of a U. The remaining appliances—refrigerator, microwave and double ovens—were placed on a third leg and grouped close. "It became a wall of functions, but there's also room on a small counter to set things down," he says. Having two wall ovens rather than a big oven beneath the range top also cuts bending and allows space for storage. For good illumination, there are recessed cans and pendants. And for those chilly Northern days and nights, the kitchen gets additional warmth from the fireplace in the adjacent family room.



Large windows highlight the crisp apple green of the cabinets and island as well as the natural earth tones used throughout this kitchen.

ABOVE LEFT: A close grouping of appliances on one wall makes for a more efficient use of space.



DESIGNER:

Mark Larson, AIA; Scott Durand
Rehkamp Larson Architects, Inc.
2732 West 43rd St.
Minneapolis, MN 55410
612-285-7275

rehkamplarson.com

LOCATION: Bloomington, MN

DIMENSIONS:
14' by 12'

>>> SPECIAL FEATURES:

Scandinavian aesthetic through the rich green palette and quartersawn oak touches; A better designed desk area in front of a big window; A new island without any appliances but with an open end for cookbooks

- Dishwasher: Bosch
- Sink: Elkay, stainless steel undermount
- Faucet: Hamat
- Cabinetry: Custom painted Shaker-style overlay door

PRODUCTS USED:

- Refrigerator/freezer: Sub-Zero
- Range top, hood, double ovens: Dacor

Kitchen
SOLUTIONS**2008 WINNERS**

BEST ADVICE FROM TOP DESIGNERS



RIGHT: A multitude of work stations and plenty of storage space define this clean, spare, Prairie-style kitchen.

LEFT: The handsome island, covered with black honed granite, stands out against a background of rich wood and high-gloss stainless steel.

hosting a crowd

FRANK LLOYD WRIGHT-STYLE HOUSE
INSPIRES FUNCTION ON A GRAND SCALE**WISH LIST**

- Beautiful design
- Seamless integration with rest of house
- Excellent design and appliances for gourmet cooking

When the owners of a brand new house in suburban St. Louis wanted to take full advantage of the made-to-order benefits offered by new construction, they hired builder Claybridge Homes and interior designer Caryn Burstein of CLB Interiors to create their ideal kitchen layout and accoutrements. Because of their Asian heritage, they also asked Burstein to

adhere to the principles of feng shui.

In the kitchen, situated in the center of the home since meal preparation is central to family togetherness, she designed custom, clean-lined cabinets with a simple Shaker door style to complement the Frank Lloyd Wright-style architecture of the home. She arranged cabinets both on an oversized island at the center of the room and on the room's four perimeter walls. The island, surfaced in handsome Absolute Black honed granite, contains a second sink for additional prep work. One of the kitchen walls contains a microwave, toaster and under-counter refrigerator; a second wall houses the big refrigerator/freezer and wall ovens. The third is actually a counter with stools and the fourth contains the six-burner range and griddle. The two perimeter zones with counterspace were surfaced in lighter green granite to contrast with the black granite, as well as with the rich, dark cherry cabinetry with honey finish, oak floorboards and dark slate backsplashes. Burstein chose Sub-Zero and Viking appliances. "It's an elegant room and it functions well. It's the perfect kitchen for indulging the inner chef in all family members," says Burstein.

For sit-down kitchen meals, there's a windowed breakfast corner. The spacious square footage also allowed room for a butler's pantry with glass shelves to store the owners' extensive collection of cookbooks.



DESIGNER:
Caryn Burstein
CLB Interiors
8125 Maryland Ave.
Clayton, MO 63105
314-721-3232

clbinteriors.com

LOCATION: Clayton, MO

DIMENSIONS:
15' by 20'

>>> SPECIAL FEATURES:

To be able to entertain on a grand scale; A cooking/entertaining space designed especially for children, with under-counter refrigerator; Quality Sub-Zero and Wolf products

PRODUCTS USED:

- Refrigerator/freezer, undercounter refrigerator: Sub-Zero
- Range, double ovens/microwave: Wolf
- Sink: Elkay
- Cabinets: Custom design from CLB Interiors, cherry



Kitchen
SOLUTIONS

2008 WINNERS

BEST ADVICE FROM TOP DESIGNERS



easy access & cleanup

A RENOVATED KITCHEN WHERE
COOKING IS THE FOCAL POINT

WISH LIST

- Better, more efficient workspace
- Higher quality appliances and other design elements
- More natural and artificial light

It was after adding on a family room to the rear of their 1950s ranch-style home in suburban Columbus, Ohio, and remodeling the adjacent kitchen that the homeowners realized that the new layout was unsatisfactory. The biggest problem was that the addition and remodeling left no direct path from the front door to the family room, which made cooking and cleanup difficult. But instead of abandoning hope, they called in a new team of designers—Jeff Brown and Monica Miller of J.S. Brown &

Company—to make some necessary changes.

"Everyone cut through the kitchen, which was awkward, especially at holidays with lots of people," says Brown. One thing led to another and his firm decided to reconfigure the front entrance so the door lined up with the family room for easy access. They also opened a wall between the kitchen and the new front foyer so circulation improved between those spaces. And although the owners wanted some separation between the kitchen and family room, they did want the areas to be visually linked. To make this feasible, Brown and Miller raised an existing beam that separated the rooms and placed a breakfast area in the family room.

Although many homeowners come to design experts with pages of magazine photographs, they may still be unsettled on the exact looks and features they desire. Such was the case here, but Brown and Miller spotted some common themes: The kitchens these homeowners favored featured inset doors and drawers, and a U-shaped layout. These elements were incorporated into the focal point of the room—a large range with a wood-paneled hood and brackets placed at the curved part of the U. The room's interior solid long wall was fitted with maple cabinets with inset doors to match the hood. These doors also face a refrigerator/freezer. For contrast, many cabinets along this wall were painted white. The third leg of the U contains a low curved wall that divides the kitchen from the family room and is paneled in beadboard. It was designed to function as a breakfast bar and accommodate the sink and dishwasher. The remodeled kitchen is brightened by natural light and recessed cans. To add warmth to the wood and white expanses, countertops are surfaced in Venetian Gold granite, backsplashes are gold-beige ceramic tile and the floor is covered in solid red oak that has been used in other rooms in the home.



The curved, self-contained layout keeps everything needed in one easy-to-work-in space.

ABOVE LEFT: With the new remodel, the family room is directly accessible from the front door, improving circulation in the kitchen.



DESIGNER:

Jeffrey S. Brown and
Monica Miller, CKD/CBD
J.S. Brown & Company Inc.
1522 Hess St.
Columbus, OH 43212
614-291-6876

jsbrowncompany.com

LOCATION: Dublin, OH

DIMENSIONS:

15' by 20'

>>> SPECIAL FEATURES:

Uninterrupted entranceway into the kitchen for better circulation; Cooking station as a focal point of the workspace; Oversized skylights combined in one large unit in the center of the kitchen

PRODUCTS USED:

- Refrigerator/freezer, wine cooler: Sub-Zero
- Range: Wolf
- Dishwasher: Asko
- Sink: Elkay
- Faucet: Kohler
- Microwave: GE
- Cabinetry: Woodharbor Cabinetry
- Countertops: Granite
- Backsplash: Seneca ceramic tile

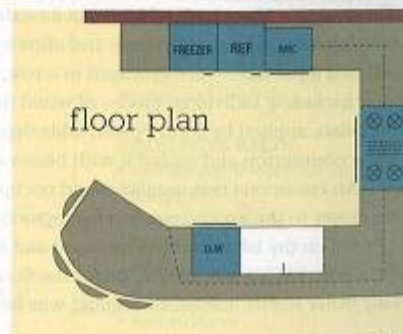

kitchen
SOLUTIONS**2008 WINNERS**

BEST ADVICE FROM TOP DESIGNERS



open design for an active family

A CORNER SINK TAKES IN THE VIEW IN THIS LARGE, OPEN ROOM DESIGNED FOR ENTERTAINING

WISH LIST

- Cottage-style cabinetry to fit the nautical-style exterior of the house
- Quartz countertops for practicality and good looks
- Large island for kids to eat casually and to use as prep area

When builder Bob Meringa, owner of Platinum Custom Homes (platinumcustomhomes.net) in Byron Center, Michigan, near Grand Rapids, decided to build a house for his family—wife Amy and three children, all under 7 years of age—he opted for a novel two-story “coastal” style design with nautical dark blue siding and crisp white trim. With help from designers Doug Bakker and Jennifer Portuna at Starlite Kitchens & Baths, Meringa put together a kitchen with a highly traditional look that’s also functional.

Whether it’s just the family gathering for meals, or extended family or friends coming to visit, the large, open room was designed to seat varying numbers, particularly since Meringa designed the house without a separate formal dining room. At the large cherry island, four can

sit at stools. The dark wood island was built to resemble a piece of furniture, with turned legs in the corners, base molding and a quartz countertop of dark blue with black, gray and taupe flecks. With a sink, microwave drawer and sufficient elbow room, the island also functions as a prep center. The double ovens have Trivection technology to provide optimal texture and crispiness to foods—in less time.

Other appointments give the room additional punch: a hood with hearth-style detailing, a backsplash of tumbled limestone bricks laid in a herringbone pattern, a two-sided fireplace between the hearth and family rooms, glass-fronted upper cabinets that can be illuminated and a pantry door with a magnetic chalkboard. Walls were painted a khaki color that complements the maple flooring, which resembles a hand-scraped wood surface on a boat deck. The windows above the sink offer sweeping views of the property and a nearby ravine.

The hearth room beyond the kitchen can fit more diners when necessary—a dining room table expands to seat 15. There’s still more room to sit and schmooze in the adjacent three-season screened porch with a stone fireplace; this space is favored for Sunday brunches and summer barbecues. “These are the areas where people come and hang out when they’re over or where we convene when it’s just our family,” Meringa says.

PHOTOGRAPHY: IAN BASSOCK; PAINT: BEASOCK; PAPER: PHASE AND TRAP; PHOTOGRAPHS: BRAND FLORES/M





DESIGNER:

Doug Bakker and Jennifer Fortuna
 Starlite Kitchens & Baths
 365 84th St., SW
 Byron Center, MI 49315
 616-583-9304
 starlitekitchens.com

LOCATION: Byron Center, MI

DIMENSIONS:

17' by 12'

>>> SPECIAL

FEATURES:

Large range hood in a hearth style; Stacked cabinetry with trim molding between the cabinets and stacked crown molding at the ceiling for a sturdy, durable look; Microwave drawer for convenience

PRODUCTS USED:

- Refrigerator/freezer, cooktop, double ovens: GE Profile
- Cabinetry: Haas Cabinet Company Inc.
- Sinks: Elkay, stainless
- Faucets, pot filler: Wenzel
- Countertop: Quartz, Bradford from Cambria
- Microwave drawer: Sharp
- Floor: Maple, Mannington
- Backsplash: Tumbled limestone in 2" by 4" bricks with an insert in a herringbone pattern and a chair rail border, also in limestone
- Faucets: Kohler (prep); Grohe (main)
- Decorative Lighting: Oggetti

Contemporary stainless steel appliances give this roomy, classic kitchen a modern twist.

ABOVE LEFT: Crisp white woodwork creates a cottage feel.

ABOVE RIGHT: A herringbone backsplash supports a convenient pot-filler faucet.

kitchen

SOLUTIONS

2008 WINNERS

BEST ADVICE FROM TOP DESIGNERS



deluxe details

PAINTED RAISED-PANEL CABINETS SERVE UP
FRENCH FLAIR IN AN AMERICAN CLASSIC

WISH LIST

- Eat-in area for family to dine comfortably
- Raise ceiling for a more open feeling
- Maintain as many of the room's windows as possible but remove some mullions

Because they had one young child and another on the way, this couple decided to wait to move into their new suburban home until the remodeling work was completed. "They were buying the house for the area rather than the house itself and knew they wanted it mostly gutted as well as enlarged, but not torn down," says designer Monica Miller, whose Columbus, Ohio-area-based firm worked on the entire home's redesign.

A two-story addition went on the front to include an office on the ground level with a master suite above.

At the rear, a wall between the work area of the kitchen and dining area was taken down, closets were removed, a section of the ceiling was raised about 9 inches and a screened porch was incorporated to give the owners a dining nook. With the enlarged area gutted, Miller had the luxury of planning the room in different zones to accommodate the homeowners' needs instead of designing around the traditional work-triangle formula. Miller also placed cabinets and equipment carefully and removed mullions from the tops of the new windows so they wouldn't block views of a beautiful ravine.

Because of the home's French-cottage ambience, Miller selected traditional maple cabinets with a square raised-panel door style, which she had painted in white and glazed slightly to add patina. For contrast, she built the desk and a pantry from cherry that was also glazed. All countertops are the same off-white Juparana Delicatus granite with a bold pattern of black and brown swirls. "Because of the room's size, we needed something dramatic," says Miller. Even though the new room was much larger, it still wasn't big enough for an island, so Miller placed the main cooking station—a range top—on one wall with drawers beneath for pots and pans. On the opposite wall, she added two more ovens and a warming drawer. To lend some additional artistry to the room, mosaic tile designs were incorporated behind the range and wet bar (not pictured), select cabinets were fronted with glass to display items, and lower cabinets were built on feet and fronted with turned posts and columns to resemble furniture. An oak hardwood floor in the kitchen matches floors throughout the home, helping to make the kitchen look like it has always been there.

Anchoring an otherwise all-white kitchen is a bold desk in the same cherry wood as the pantry.

ABOVE LEFT: An expanse of unadorned windows, off-white granite countertops and mosaic-tiled backsplashes create a clean, bright space.



DESIGNER:

Monica Miller, CKD, CBD
 J.S. Brown & Company Inc.
 1522 Hess St.
 Columbus, OH 43212
 614-291-6876

jsbrowncompany.com

LOCATION:

Upper Arlington, OH

DIMENSIONS:

28' by 11" kitchen;
 14' by 7'6" dinette

>>> SPECIAL

FEATURES:

Wet bar with mosaic
 backsplash; Built-in wood
 desk area that looks
 old and matches a pantry;
 Dinette area in a former
 screened porch

PRODUCTS USED:

- Range top: Wolf
- Double ovens,
 warming drawer:
 Thermador

- Refrigerator/freezer,
 wine cooler: Sub-Zero
- Dishwasher: Asko
- Sinks: stainless, Elkay;
 copper sink, Bates and
 Bates
- Faucets: Danze
- Cabinets: Zang
- Granite: Juparana
 Delicatus
- Tile: Walker Zanger



Kitchen

SOLUTIONS

2008 WINNERS

BEST ADVICE FROM TOP DESIGNERS

SINKS & FAUCETS

go with the flow

SMART SHAPES IN FASHIONABLE FINISHES,
OVERFLOWING WITH CONVENIENT FEATURES



FOR YOUR SHOWERING PLEASURE

Soothing or stimulating? Hansa's new tilting Hansa2day showerhead offers you both sensations. Play it straight with the horizontal position for a needle spray from the underside of the tray. Tilt it forward and water gently rains down to calm body and soul. White with chrome or brushed nickel accents.

hansa.us.com; 678-334-2121



BEAUTY IN MOTION

With five pivoting joints that respond intuitively to touch, Kohler's new hands-free Karbon Articulating Kitchen faucet directs water exactly where it's needed with flexible precision. Polished chrome finish.

kohler.com; 800-456-4537



PRO PERFORMER

Solid stainless steel construction paired with two high-capacity bowls make Blanco's Performer an attractive essential for today's busy kitchens. Easy to clean with a long-lasting polished satin finish. Model #513-635.

blancoamerica.com; 800-451-5782



TRIM & SLIM

An elegant intersection of cylindrical forms, Danze's Parma Single Handle Trimline Lavatory faucet pairs graceful form with practical function. Available in two finishes.

danze.com; 877-530-3344

ARTFULLY INSPIRED

Part of Alchemy Glass & Light's Cienega series, the Lava sink is the result of an intricate glass fusion process. Trapping precious minerals and metals from within produces a naturally dramatic color palette so unique that no two pieces are ever the same.

alchemy-glass.com;
323-235-6606



MASTER MULTITASKER

Countertop, cutting board, colander—the Mythos modular sink from Franke is a stylishly sensible option for the busy cook.

franke.com; 800-626-5771



LUNA ECLIPSE

Sleek and seductive, Graff's Luna Lavatory faucet's streamlined design takes geometry to a higher plane. Available in either polished chrome or a satin nickel finish, it's offered with either deck- or wall-mounted handles.

graff-faucets.com;
800-954-GRAF



CENTRALLY CIRCULAR

Ergonomically designed with freely rotating functions and accessories such as cutting boards (with and without cutouts), the KWC Waterstation can be customized to suit every need. For gourmets and fast-fix cooks alike.

kwc.us.com; 678-334-2121



CURVES AHEAD

Bean-shaped with a customized, removable cutting board, Elkay's stainless steel Mystic sink offers added functionality for cleaning larger cookware and baking sheets.

elkay.com;
630-574-8484



A AGA

www.aga-rayburn.com

Alchemy Glass & Light

www.alchemy-glass.com

Amana

800-843-0304

www.amana.com

Ann Sacks Tile

800-278-TILE

www.annsacks.com

Armstrong

717-397-0611

www.armstrong.com

Asko North America

800-898-1879

www.askousa.com

B BainUltra

800-463-2187

www.bainultra.com

Bates and Bates

www.batesandbates.com

Benjamin Moore & Co.

800-344-0400

www.benjaminmoore.com

Berenson Corp.

716-833-3100

www.berensonhardware.com

Best by Broan

800-558-1711

www.bestbybroan.com

Blanco America, Inc.

www.blancoamerica.com

The Bosch Group

www.bosch.com

Bouvet

www.cabinet-bouvet.com

Bulthaup Corporation

800-808-2923

www.bulthaup.com

C CaesarStone

877-9-QUARTZ

www.caesarstoneus.com

California Faucets

800-822-8855

www.calfaucets.com

Cambria Quartz

866-CAMBRIA

www.cambriausa.com

**Candlelight
Cabinets, Inc.**

716-434-6543

www.candlelightcab.com

Ceramic Design, Ltd.

203-454-0032

www.ceramicdesignltd.com

Chicago Brass

847-926-0001

www.chicagobrass.com

Chicago Faucets

847-803-5000

www.chicagofaucets.com

**Classic Tile
& Mosaic**

310-287-0142

www.ctandm.com

Cliffside

800-873-9258

www.cliffsideind.com

Corian

800-906-7765

www.corian.com

Crate & Barrel

800-967-6696

www.crateandbarrel.com

Crossville Inc.

931-484-2110

www.crossvilleinc.com

**Custom Wood
Products, Inc.**

800-477-3130

www.cwponline.com

D Dacor Inc.

800-793-0093

www.dacor.com

**Dal-Tile
Corporation**

214-398-1411

www.daltile.com

Danze

877-530-3344

www.danze.com

D-Group

818-845-0272

**Diamond
Cabinets**

www.diamond2.com

Dornbracht

www.dornbracht.com

Draper/DBS

215-453-7661

www.draperdbs.com

DuPont Zodiac

www.zodiac.com

Duravit AG

www.duravit.com

E Electrolux

877-435-3287

www.electroluxusa.com

Elegant Additions

713-522-0088

www.elegantadditions.net

Elkay, Inc.

630-574-8484

www.elkay.com

**Elmira
Stove Works**

800-295-8498

www.elmirastoveworks.com

Enkeboll Designs

800-745-5507

www.enkeboll.com

F Fisher & Paykel**Appliances Inc.**

888-936-7872

www.fisherpaykel.com

Franke Consumer Products

800-626-5771

www.frankeconsumerproducts.com

G Gaggenau

877-4GAGGENAU

www.gaggenau.com

GE Appliances

800-626-2005

www.geappliances.com

Green Street Details, Inc.

800-275-7855

www.greenstreetdetails.com

Grohe America, Inc.

630-582-7711

www.groheamerica.com

H Haas Cabinet Co. Inc.

800-457-6458

www.haascabinet.com

Halo Lighting

www.halolighting.com

Hamat USA

866-52-HAMAT

www.hamatusa.com

Hansgrohe, Inc.

800-334-0455

www.hansgrohe-usa.com

Hardware Resources

800-463-0660

www.hardwareresources.com

**Harrington
Brass Works**

201-818-1300

www.harringtonbrassworks.com

Heath Ceramics

415-332-3732

www.heathceramics.com

Heritage Cabinet Co., Inc.

818-786-4900

www.heritagecabinet.com

**Holland Bar
Stool Co.**

800-423-1903

www.hollandbarstool.com

Houzer, Inc.

800-880-3639

www.enexsink.com

HP Austin

877-472-7469

www.hpaustin.com

Hubbardton Forge

802-468-3090

www.vtforge.com

I In-Sink-Erator

800-558-5700

www.insinkerator.com

J Jacuzzi Inc.

800-288-4002

www.jacuzzi.com

Jado Corporation

800-227-2734

www.jadousa.com

Jenn-Air

800-JENN-AIR

www.jennair.com

Julien Inc.

800-461-3377

www.julien.ca

K Kallista Inc.

888-4Kallista

www.kallista.com

Kenmore

800-349-4358

www.sears.com

Kichler Lighting

866-558-5706

www.kichler.com